

NOTES: UNLESS OTHERWISE SPECIFIED

1. MANUFACTURED AND INSPECTED IAW AS9100 QUALITY SYSTEM REQUIREMENTS.
2. ABBREVIATION USED IN TITLE IS: VALVE REGULATED SEALED LEAD ACID (VRSLA).
3. SEE DRAWING NUMBER CB-00468 AND PROCEDURE P-1000 FOR ASSEMBLY AND TEST INSTRUCTION. PROCEDURE AND ASSEMBLY DRAWINGS ARE FOR INTERNAL USE ONLY.
4. BATTERIES ARE RATED IAW INTERNATIONAL ELECTROTECHNICAL COMMISSION STANDARD 60952-1 AND RTCA STANDARD DO-293A UNLESS OTHERWISE NOTED.

| REVISIONS |             |      |          |
|-----------|-------------|------|----------|
| REV.      | DESCRIPTION | DATE | APPROVED |
|           |             |      |          |

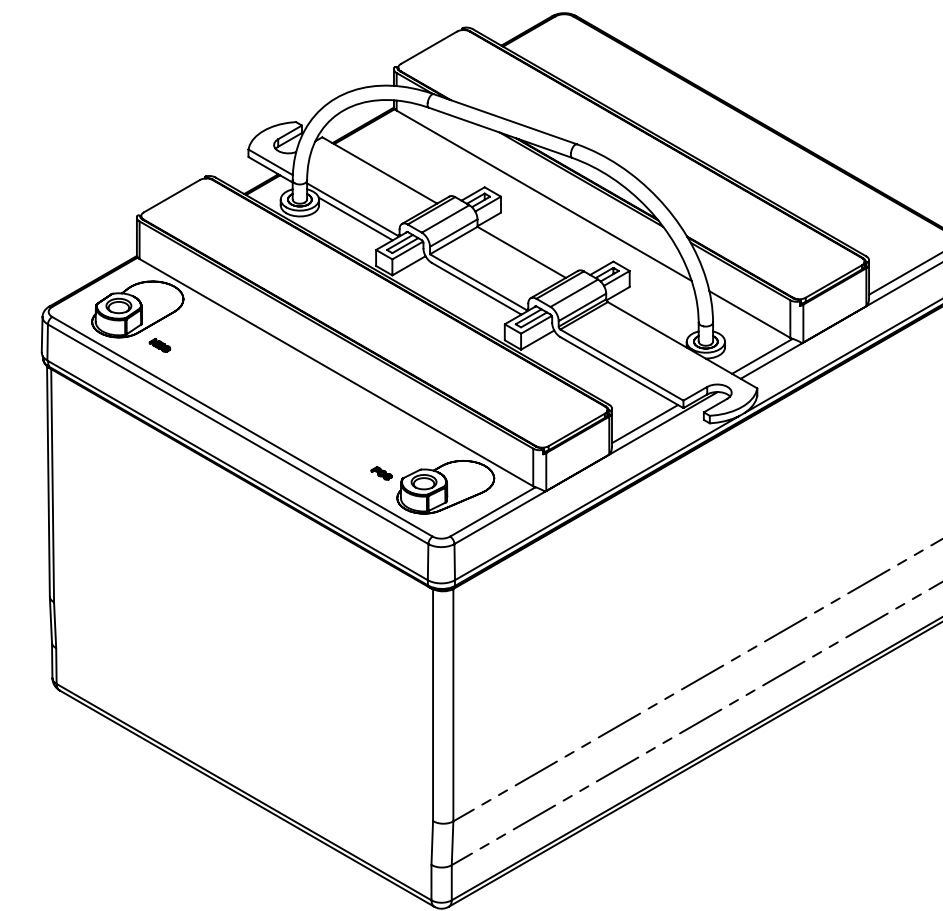
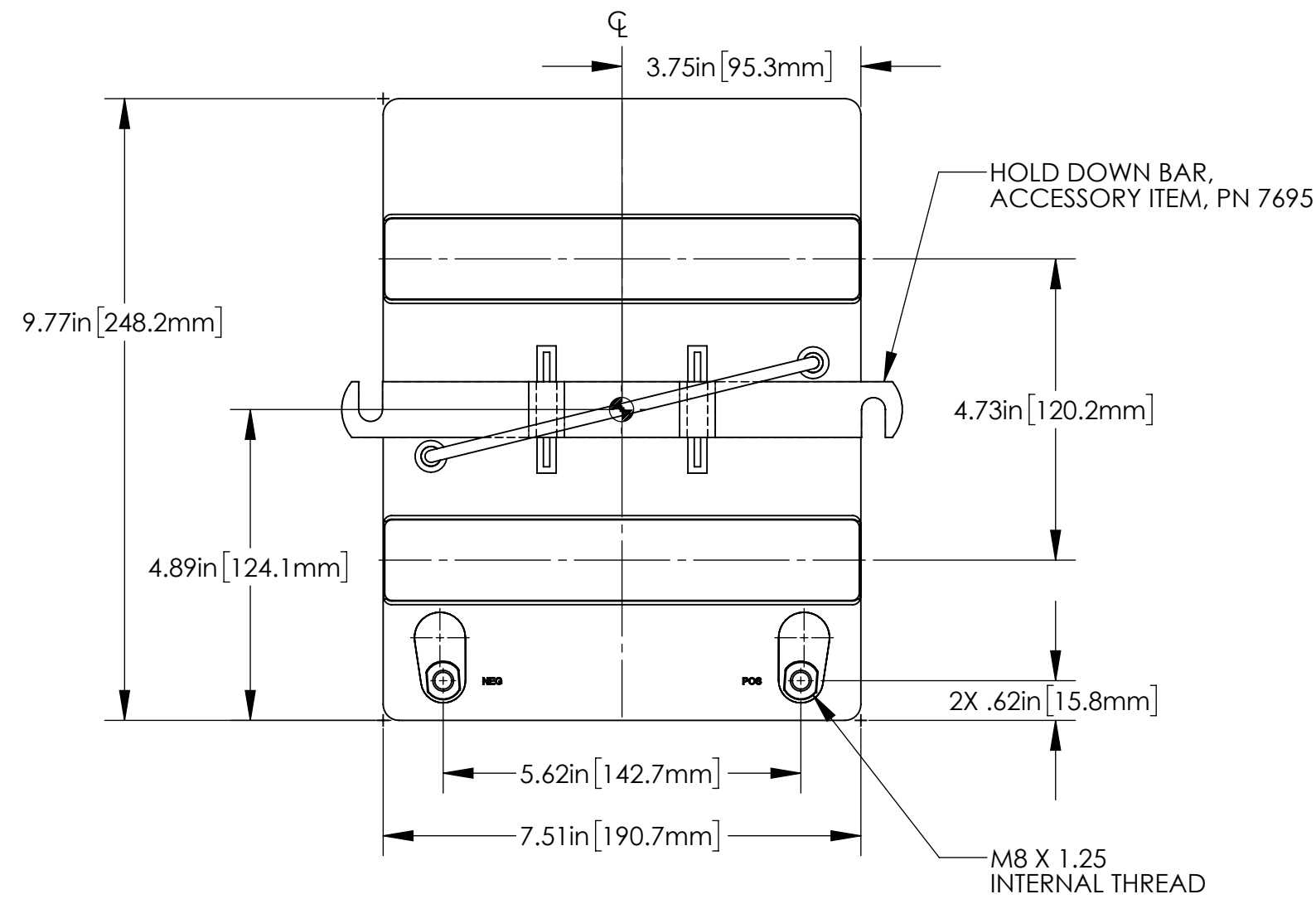

**ISOMETRIC VIEW**

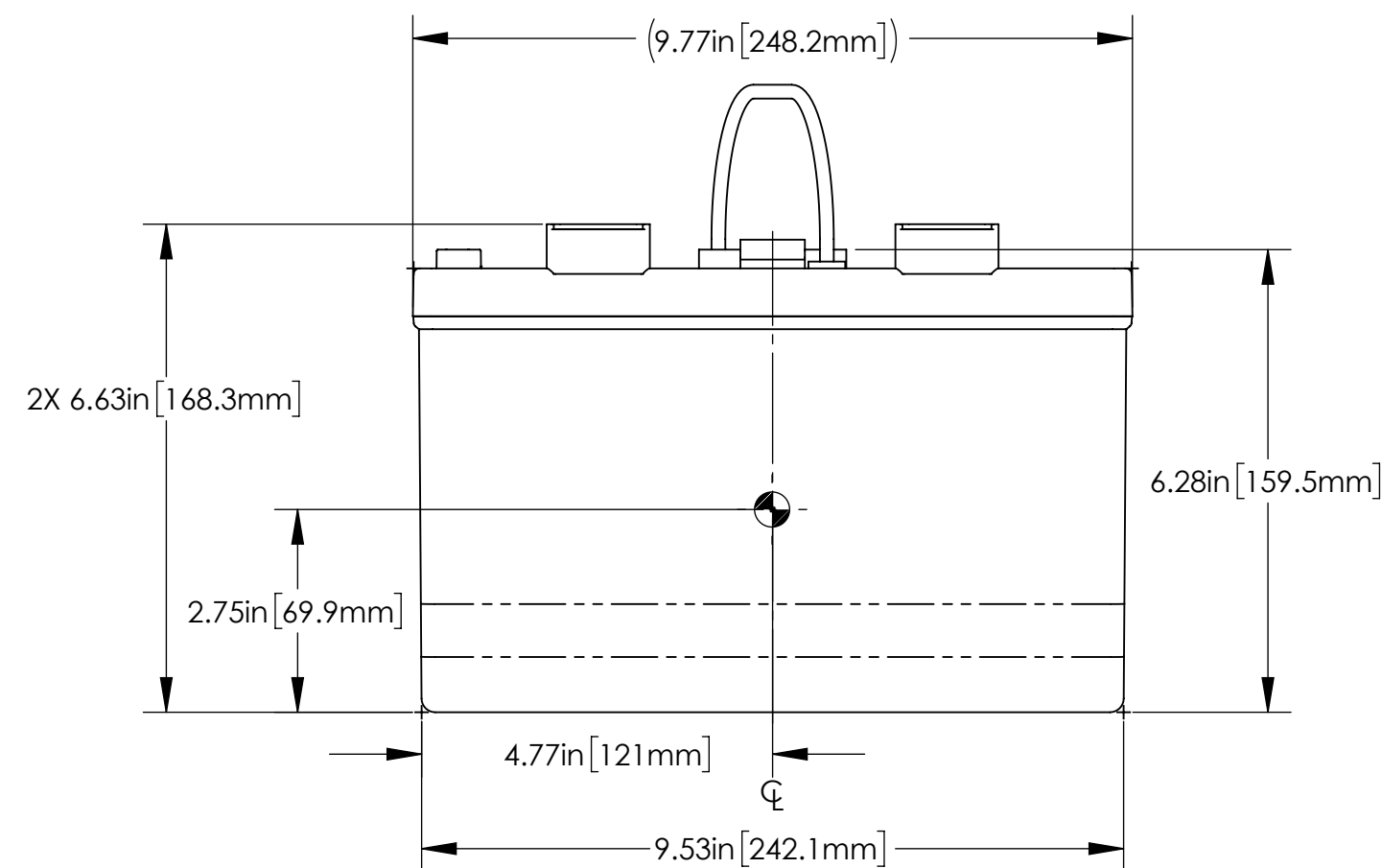
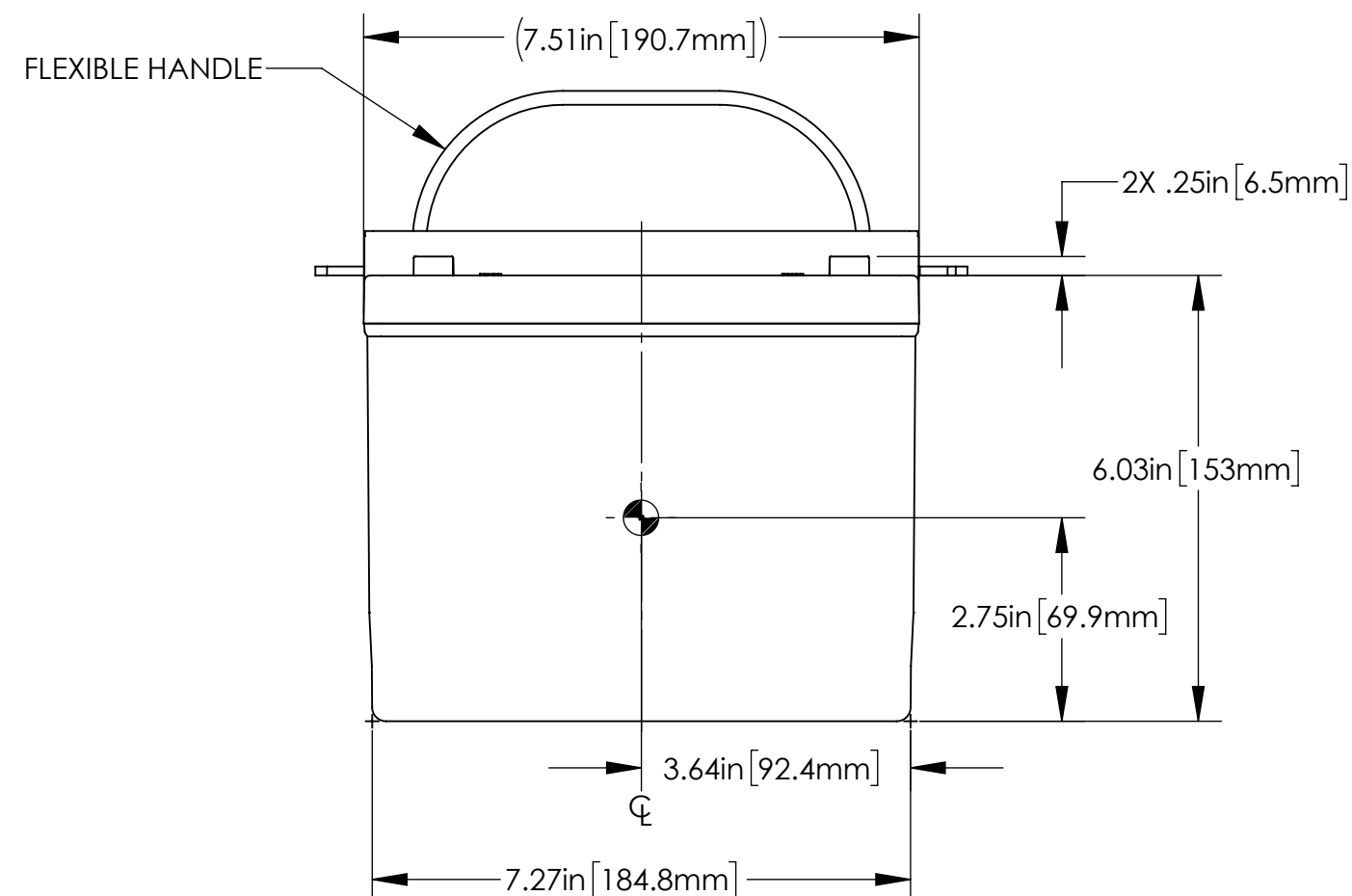

|                                |   |
|--------------------------------|---|
| PART NUMBER                    | RG-220  |
| MAXIMUM HEIGHT                 | 44.1 LBS [20.0 KG]                            |
| RATED CAPACITY, C <sub>1</sub> | 21 AH   |
| POWER RATING AT 23°C           | I <sub>pp</sub> 1100 A, I <sub>pr</sub> 800 A |
| POWER RATING AT -18°C          | I <sub>pp</sub> 800 A, I <sub>pr</sub> 600 A  |
| POWER RATING AT -30°C          | I <sub>pp</sub> 625 A, I <sub>pr</sub> 425 A  |

**ENVELOPE DRAWING**

|   |                        |             |                  |              |   |           |         |
|---|------------------------|-------------|------------------|--------------|---|-----------|---------|
| UNLESS OTHERWISE SPECIFIED DIMENSIONS ARE IN INCHES TOLERANCES ARE: |                        |             | CONTRACT NO.     |              | CONCORDE BATTERY CORPORATION<br>2009 SAN BERNARDINO RD, W. COVINA, CA 91790 |           |         |
| FRACTIONS   | DECIMALS               | ANGLES      | APPROVALS        | DATE         | TITLE   |           |         |
| ±1/32   | .XX ±.06<br>.XXX ±.030 | ±1°         | DRAWN J. SUMMERS | 07/31/19     | BATTERY, VRSLA, 24 VOLT   |           |         |
| TREATMENT   | NONE                   | CHECKED NS  | 12/19/19         | SCALE        | 1:2   | CAGE CODE | DWG NO. |
| FINISH  | NONE                   | APPROVED PH | 1/13/20          | C            | 63017   | RG-220    | REV     |
| SIMILAR TO  | CALC WT                | ISSUED DH   | 1/13/20          | SHEET 1 OF 1 |   |           |         |